

AJAX RescueTools

AIR HAMMER RESCUE KITS

Choice of Champions



An Extra Hand in Extrication

AJAX RescueTools

10801 Franklin Avenue Franklin Park, Illinois 60131 800.323.9129

www.ajaxrescuetools.com





911-RK SUPER DUTY KIT

Choice of Champions

Our best kit featuring our most powerful and hardest hitting hammer. Includes non-turn and turn-type chisels for universal applications.

811-RK HEAVY DUTY KIT

Features heavy-duty hammer with longer piston stroke for more powerful cutting action. Includes non-turn and turn-type chisels.



711-RK STANDARD DUTY KIT

Complete kit with everything necessary to hook up to an air tank and begin extrication work.



CONTENTS

THE AIR HAMMERS

PART NO. DESCRIPTION

- (1) 1976 Hammer for .498-in. shank tools
 - (1) 3700-3 Retainer
 - (1) 8245H Regulator
 - (2) 8260 Ergo Chisel Grip (non-turn)
 - (1) 3190-12 12-in. Moil Point (non-turn)
 - (2) 3189 Double Blade Panel Cutter (non-turn)
 - (2) 3180 Kwik Cutter (non-turn)1
 - (2) 3180-18 8-in. Kwik Cutter (non-turn)
 - (2) 3089 Double Blade Panel Cutter (turn-type)
 - (2) 3080 Kwik Cutter (turn-type)
 - (2) 3080-18 18-in. Kwik Cutter (turn-type)
 - (1) 1030 15-ft., 3/8-in. Hose
 - (1) 1045 3/8-in. Male Connector(1/4-in. NPT hammer)
 - (1) 1048 3/8-in. Male Connector(1/4-in. NPT regulator)
 - (1) 1052 3/8-in. Female Coupler (3/8-in. NPT hose)
 - (1) 8246 Gauge Guard
 - (1) 5317 20-in. Steel Kit Box
 - (1) 8259 Kit Box Liner
 - (1) 1074 4-oz. Oil
 - (1) 674-RT Trim Removal Tool **NEW**
- Same as 911 RK with (#1985) 1/2-in. Impact Wrench and #1986 11-piece (fractional) socket set.



1976
.498 Shank
Super-Duty
Air Hammer

911-RK SUPER DUTY KIT

SPECIFICATIONS

Blows per Minute	Bore Size	Stroke Length	Air at 90psi	Overall Length	Net Wgt
1560	3/4"	2-11/16"	7 cfm	9-1/2"	6 lbs.

- (1) 5164 Hammer for .401-in shank tools
 - (1) 3300-42 Retainer
 - (1) 8245H Regulator
 - (2) 3159 Double Blade Panel Cutter (non-turn)
 - (2) 3156 Kwik Cutter (non-turn)
 - (2) 3156-18 18-in. Kwik Cutter (non-turn)
 - (2) 909-9 Panel Cutter (turn-type)
 - (2) 932 Kwik Cutter (turn-type)
 - (2) 932-18 18-in. Kwik Cutter (turn-type)
 - (1) 929 Ripper Chisel (turn-type)
 - (1) 940 Moil Point (turn-type)
 - (1) 998 15-ft., 1/4-in. Hose
 - (2) 992 Male Connector (1/4-in. NPT hose and hammer)
 - (1) 996 Male Coupler (1/4-in. NPT regulator)
 - (1) 993 Female Coupler (1/4-in. NPT hose)
 - (1) 8246 Gauge Guard
 - (1) 5317 20-in. Steel Kit Box
 - (1) 8259 Kit Box Liner
 - (1) 1074 4-oz. Oil
 - (1) 674-RT Trim Removal Tool **NEW**
- Same as 811 RK with (#1985) 1/2-in. Impact Wrench and #1986 11-piece (fractional) socket set.



5164
.401 Shank
Heavy-Duty
Air Hammer

811-RK HEAVY DUTY KIT

SPECIFICATIONS

Blows per Minute	Bore Size	Stroke Length	Air at 90psi	Overall Length	Net Wgt
2800	3/4"	3-11/16"	4 cfm	10"	5 lbs.

- (1) 1974 Hammer for .401-in. shank tools
 - (1) 3300-U Retainer
 - (1) 8245H Regulator
 - (2) 3159 Double Blade Panel Cutter (non-turn)
 - (2) 3156 Kwik Cutter (non-turn)
 - (2) 3156-18 18-in. Kwik Cutter (non-turn)
 - (1) 940 Moil Point (turn-type)
 - (1) 998 15-ft., 1/4-in. Hose
 - (2) 992 Male Connector (1/4-in. NPT hose and hammer)
 - (1) 996 Male Coupler (1/4-in. NPT regulator)
 - (1) 993 Female Coupler (1.4-in. NPT hose)
 - (1) 8246 Gauge Guard
 - (1) 5317 20-in. Steel Kit Box
 - (1) 8259 Kit Box Liner
 - (1) 1074 4-oz. Oil
 - (1) 674-RT Trim Removal Tool **NEW**
- Same as 711 RK with (#1985) 1/2-in. Impact Wrench and #1986 11-piece (fractional) socket set.



1974
.401 Shank
Standard-Duty
Air Hammer

711-RK STANDARD DUTY KIT

SPECIFICATIONS

Blows per Minute	Bore Size	Stroke Length	Air at 90psi	Overall Length	Net Wgt
2100	3/4"	3-1/2"	4 cfm	9-1/2"	5 lbs.

AJAX RESCUE TOOLS...



Since 1946, Ajax Tool Works has been recognized as one of America's finest quality manufacturers for specialty tools and accessories. In discovering a need for our particular type of cutting tools, Ajax became a pioneer in emergency extrication tools, introducing our first air hammer rescue kit almost 40 years ago. From this single kit has grown a complete line of rescue kits designed to meet any department's need or budget from the smallest volunteer rescue squad to the largest municipal fire department.

Ajax Rescue Tools have been designed specifically and are field-proven for extrication and other types of emergency cutting, such as factory doors, casement windows and fire doors. They can also be used for chipping concrete in confined space rescues.

Something in the Air!

There are several means of extrication devices on the market today, but none offer the versatility of air tools. Ajax Rescue Tools give you the speed, the portability and the dependability you need when every second counts!

You will appreciate the way the tool begins operating immediately. You'll never have to wait for an electric or gas-powered motor to turn over and there are no potentially dangerous flying sparks. When you release the trigger, the tool stops instantly, unlike some cutting tools that gradually slow down, leaving the operator vulnerable.

Every Ajax Air Hammer Rescue Kit is completely portable and compact enough to be easily carried in police cars and rescue vehicles wherever your rescue team is needed. They can be operated with fresh air tanks, compressors, nitrogen bottles, cascade systems or air brake outlets and may be used with both 2216 psi and 4500 psi air tanks.

You can also use our rescue kits as a complement to other, heavier equipment. While one rescue team begins extrication with one type of equipment, another team can begin entry procedures using an entirely different source of power.

About The Kits

Each Ajax Air Hammer Rescue Kit series features an air hammer specially selected for its durability. This is extremely important as they sometimes must be adjusted to a higher operating pressure to cut through heavier steel.

Every kit includes an Ajax Kwik Change Retainer. This retainer was originally developed by Ajax to hold the cutting tool securely in place, yet allowing you to change tools in a matter of seconds during emergency procedures. In addition, the retainer also allows the use of Ajax Exclusive non-turn tools. These tools can be indexed into different positions to allow one-hand operation of the hammer when necessary. The Ajax Kwik Change Retainer is the only retainer which lets you use both turn and non-turn type tools.

Ajax special cutting tools are manufactured from the highest quality alloy steels and are made specifically for gaining fast entry into wrecked automobiles. Even though these tools look similar to those found in many body shops and supply stores, don't be fooled! Only Ajax gives you the cutting edge needed for consistently fast extrication work.

Our high-pressure regulator has a universal design which lets you use either 2216 psi or 4500 psi air tanks without having to change the regulator. It is rated at an operating pressure up to 300 psi, **well above our recommended settings.**



WHEN EVERY SECOND COUNTS!



A safety blow-off valve prevents you from exceeding capacity level. The regulator lets you operate the tool at the proper air pressures essential for the most efficient operation while allowing you to use extra air power when needed. Normal body metals, A, B and C posts, quarter panels and firewalls require only 90 psi. Heavier metals, such as Nader pins, door hinges, etc., require 150-160 psi. After some practice, an operator can usually cut three sides of a roof to extricate a victim in just 60-90 seconds. An optional 1/2-in. impact wrench, 3/8-in. air ratchet and sockets are available for removing bolts on door hinges, seat backs and more.

Our 911 Series Super Duty Kits feature the most powerful air hammer available. This industrial strength tool can make even the most difficult cuts. The 911-RK features 13 chisels in both turn and non-turn styles and premium couplers and connectors. This is the choice of champion extrication teams throughout the world. **For the money, you won't find a more complete and powerful rescue kit!**

The 811 Series Heavy Duty Kits contain 14 chisels in turn and non-turn styles; the most we have ever put into a kit. The air hammer included is more powerful and cuts faster than the 711-RK.

A truly outstanding value!

The 711 Series Standard Kits now have a longer-barreled hammer for more powerful and quicker cutting than the

old 711-RK. They include 6 non-turn chisels and 1 turn-type moil point chisel.

Every kit includes a 15-foot heavy-duty double-braided hose, couplers and connectors, protective gauge guard, air tool oil and a heavy-duty 20-inch mechanics kit box with dual latches to securely store your kit while conveniently fitting into any rescue vehicle you may have. In addition, a complete selection of replacement and optional equipment is offered (see pages 6-8.)



Extrication Competitions

When we say that Ajax Rescue Tools are the *Choice of Champions*, we're not just bragging. Since 1983, Ajax Air Hammer Rescue Kits have been used in every International Extrication Competition. This event brings together 25 of the top rescue teams from around the world as they demonstrate the latest techniques in vehicle extrication. Teams are judged on their response to a staged accident scenario with emphasis being placed on safety and proper tool usage. Over the years, Ajax has been the preferred tool of extrication specialists.



The true value of these competitions is the interaction and continuing education of these teams so they can use what they learn in a real life emergency.

Ajax has earned a reputation for reliability not only in the competition forum but on the streets as well. Ajax has a great admiration for the brave men and women involved in the fire and rescue industry and we are proud that we can play a part in it.



CUSTOMIZE YOUR RESCUE KIT

711 & 811 SERIES

911 SERIES

.401 TURN TYPE

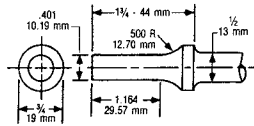

.401 NON-TURN TYPE

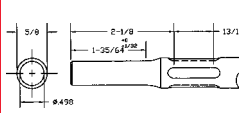

.498 TURN TYPE

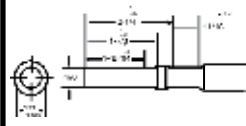

.498 NON-TURN TYPE

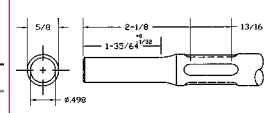

POINT STYLE

KWIK CUTTER



Used for most cutting applications

DOUBLE BLADE PANEL CUTTER



For ripping sheet metal

MOIL POINT



For chipping concrete, confined space rescue

FLAT CHISEL 3/4" WIDE



For cutting hardened bolts

RIPPER

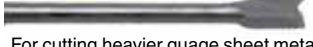

For cutting heavier gauge sheet metal

	PART NO.	LENGTH	PART NO.	LENGTH	PART NO.	LENGTH	PART NO.	LENGTH
Kwik Cutter	932-PL	8 1/2"	3156-PL	8 1/2"	3080-PL	9"	3180-PL	9"
Used for most cutting applications	932-18-PL	18"	3156-18-PL	18"	3080-18-PL	18"	3180-18-PL	18"
Double Blade Panel Cutter	909-9-PL	9"	3159-PL	9"	3089-PL	9"	3189-PL	9"
For ripping sheet metal								
Moil Point	940-PL	7"					3190-12-PL	12"
For chipping concrete, confined space rescue								
Flat Chisel 3/4" Wide	910	6 1/2"	3102	7 1/2"	3042-PL	8 1/2"	3182-PL	7 1/2"
For cutting hardened bolts	910-11-PL	11"						
	910-18	18"	3102-18	18"			3182-18	18"
Ripper	929-PL	9"						
For cutting heavier gauge sheet metal								



PART NO.	DIAMETER	LENGTH	PART NO.	DIAMETER	LENGTH
998	1/4"	15'	1030	3/8"	15'
988	1/4"	25'	1032	3/8"	25'
989	1/4"	50'	1034	3/8"	50'

NOTE: Supplied with male coupler on one end and male thread other end. Order couplers and connector separately.

PART NO. DESCRIPTION



- 992 1/4" NPT Male Connector (hose and hammer)
- 993 1/4" NPT Female Coupler (hose)
- 996 1/4" NPT Male Coupler (regulator)

PART NO. DESCRIPTION



- 1044 3/8" NPT Male Connector (hose)
- 1045 3/8" NPT Male Connector (hammer)
- 1048 3/8" NPT Male Coupler (regulator)
- 1052 3/8" NPT Female Coupler (hose)

3088 Clay Spade with Ergo Grip

Used for digging in Confined Space, Trench Collapses, to remove Soil, Clay, Gravel and other types of debris.

Note: Use in Ajax "911" series rescue kit only.



8260 Ergo-Chisel Grip

Patented vibration reducing ergonomic isolator slides onto chisel body for secure grip and less user fatigue. Fits .498 turn-type and .401 and .498 non-turn chisels.



WITH THESE OPTIONAL ACCESSORIES

RESCUE KIT ACCESSORIES



8245H High-Pressure Regulator

For use with 2216 PSI Tanks or 4500 PSI air tanks. Equipped with a safety blow-off valve to prevent accidental setting of pressure beyond capacity.

8255H Low-pressure gauge
8257H High-Pressure gauge



8246 Plastic Gauge Guard

Ajax Quick Change Safety Retainer

Lets you replace your cutting tool in seconds!

Kwik Change Retainer:
3300S-9 (711 Series)
3300S-42 (811 Series)
3700S-3 (911 Series)



"Kwik Change Retainer" accepts Ajax exclusive NON-TURN tools which allow for one hand use of tool when necessary or standard collar tools.

Ajax Quick Change Safety Retainer with front Shield keeps retainer sleeve from inadvertently being moved backward during operation.

Non-Turn Collar



Standard-Turn type Collar

Retainer Repair Kit

Includes sleeve, snap ring and ball bearings.

3300-RPK - for 711 and 811 series
3700-RPK - for 911 series



1985

1/2" Impact Wrench

1985 - SPECIFICATIONS

Torque ft/lbs. Working/Max	Shank	Retainer	Side to Center	Overall Length	Wgt. Lbs.
180 / 325	1/2" sq.	Friction Ring	1 5/16"	9"	5 1/2"

1/2" Drive Socket Sets

- 1986** 11-pc. Fractional Deep Impact Socket Set (Includes: 3/8, 7/16, 1/2, 9/16, 5/8, 11/16, 3/4, 13/16, 7/8, 15/16, 1 inch sizes)
- 1991** 10-pc. Metric Deep Impact Socket Set (Incl. 10mm thru 19mm sizes).



1988

3/8" Ratchet Wrench

1988 - SPECIFICATIONS

Free Speed	Max. Torque Ft. Lbs.	Wt. Lbs.	Lgth	Head Hgt.	Diam.
160 rpm	45	2 1/2	10"	13/16"	1 3/8"

3/8" Drive Socket Sets

- 1987** 8-pc. Fractional Deep Impact Socket Set (Includes: 5/16, 3/8, 7/16, 1/2, 9/16, 5/8, 11/16, 3/4 inch sizes).
- 1992** 12-pc. Metric Deep Impact Socket Set (Incl. 8mm thru 19mm sizes).



1989

Cut-Off Tool

1989 - SPECIFICATIONS

Speed	Cutting Depth	Wgt. Lbs.	Length	Wheel Size	Rec. PSI
23,000 rpm	3/4"	1 2/3	6 3/4"	2 7/8" x 1/6" x 3/8"	90

1990 (6) Standard-duty Cut-off Wheels

Air Tool Oil

- 1074** Air Tool Oil (4 oz.)
1075 Air Tool Oil (1 qt.)





Augment Your Rescue Arsenal With Ajax Bars!

PRY BARS (Nickel Chrome Plated)

Forged from the finest alloy steel and tempered for added strength.

Cat. No.	Stock Size	Length
9118-PL	21/32"	18" OAL
9124-PL	3/4"	24" OAL
9130-PL	7/8"	30" OAL
9146	7/8"	46" OAL
9154	1-1/16"	54" OAL

RESCUE BAR Goose Neck/Pinch Point (Nickel Chrome Plated)

Goose neck prys open car hoods for quick and easy access.

Cat. No.	Stock Size	Length
678-PL	7/8"	36" OAL
679-PL	1"	48" OAL

CROWBAR WEDGE POINT

Cat. No.

9160W 1-1/4" sq. X 60" Wedge Point/Lining Bar

CROWBAR PINCH POINT

Cat. No.

9160P 1-1/4" sq. X 60" Pinch Point/Lining Bar

The "A" Jack from AJAX

Model No. AJ8000 *Versatile! Rugged! Pow-R-ful!*

Ajax's new 8000 lb. capacity "A" Jack is the best available. Built with a patented "Safety Link", the "A" Jack is the "Jack with More!" Larger base for greater stability. "Safety Link" mechanism that prevents abuse, misuse and makes operation safer. Our 48" Jack comes with a LIFETIME WARRANTY and is built to current ANSI/ASME specifications. When Safety and Dependability Matters Most, continue to rely on Ajax.

Features:

- Lift, Pull, Winch, Push, Hoist from 50 up to 8000 lbs (4 tons)*
- Patented "Safety Link" mechanism prevents abuse and misuse -- exceed rated capacity and the safety link yields, preventing further lifting of load while holding it in place.
- Cast components assure long life and trouble free operation.
- Hot roll-formed, alloy steel beam is made strong and reliable
- Beam Holes accommodate attachment of Clevis pins, chains, bolts, ropes, etc.
- Hollow, special high tensile steel handle accepts pipe/bar for added leverage and locks against beam for convenient storage.
- Extra large 38-1/2 sq. in. base is heavily ribbed for strength and load stability.



NEW Model No. 674-RT "STRIP AND PEEK" RESCUE TOOL Trim and Molding Removal Tool

The New Ajax No. 674-RT Trim and Molding Removal Tool is designed to expose the following hazards while preparing to extricate a victim from an automobile accident.

REVEAL THESE HAZARDS

1. Air Bag Canisters that have 3000 P.S.I. to 10,000 P.S.I.
2. Seat Belt Pre-Tensioners, positioned in the lower portion of the "B" post
3. Wire Looms that are connected to the Air Bags and Pre-Tensioner Systems
4. Expose the Super Structure of the vehicle prior to cutting

